

KRIDHA
PLYWOOD | LAMINATES
QUALITY KI BAAT KRIDHA KE SAATH

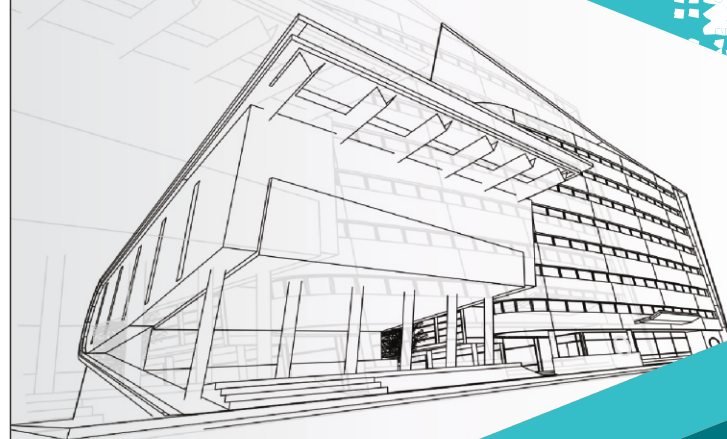

FOR AUTHENTICATION
SCAN QR CODE

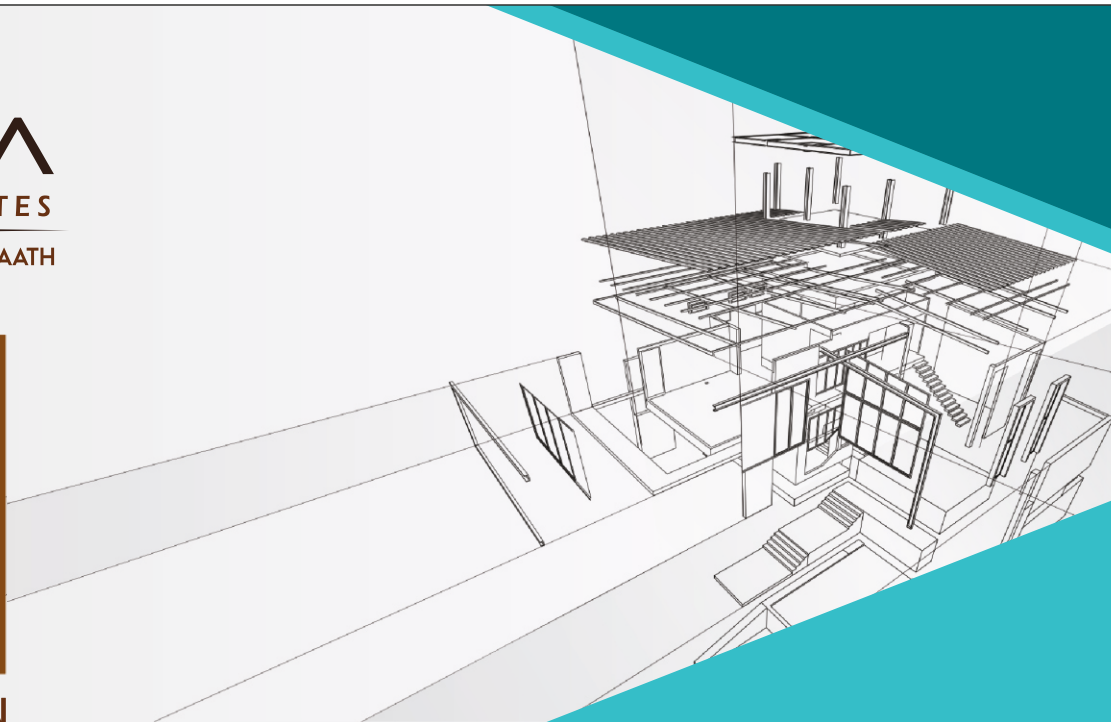

KRIDHA LAMINATES PVT LTD
www.kridhalam.com info@kridhalam.com
TOLL FREE NO.: 1 800 274 6911
Follow Us On: [f](#) [t](#) [in](#)



TECHNICAL PRODUCT CATALOGUE

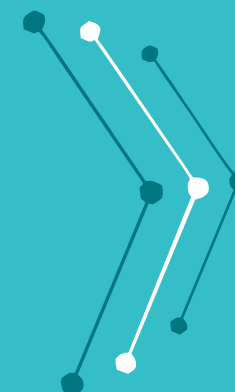

KRIDHA
PLYWOOD | LAMINATES
QUALITY KI BAAT KRIDHA KE SAATH

About Us:

Today we feel proud that KRIDHA products are one of the first preferences of market. We at KRIDHA work with a vision to provide best services in the industry of plywood and laminates. Our products cover the entire range from shuttering ply, commercial and marine grade plywood, decorative plywood, Calibrated plywood, 0.8mm laminate and 1mm laminate. We also manufacture top quality flush doors, door skin and block board catering to the diverse need of market. Our products are not only borer and termite resistant but are also designed in attractive shades and colors that give an artistic look to your home.

At KRIDHA we have always given top priority to the quality of products and services to the client. Over the years our products have been enjoying the condence and patronage of stake holders, clients and society at large. Pioneer architects and interior designers across the country prefer KRIDHA products. Wide specications of plywood that offer a unique blend of applications and functionality to specify manufacturing Re-resistant plywood that are useful in interior decoration and constructions.

We are driven by the philosophy of adding more value to our products so that our client such as architects, interior designers, artists, real estate developers, house owners, commercial establishments, retailers and many others meet their needs.

Vision & Mission



Our vision is to render the best in class products in the interior infrastructure with the latest technology and quality services. We are committed to deliver best of products guaranteed against every kind of damage and deterioration through natural agents like termites, borer and other harmful elements.

Our mission is to make available to every segment of the population the best quality products so that their worries about its availability, use worthiness and durability together with price and availability are fully addressed giving them peace of mind and full value of money.



Our Vision

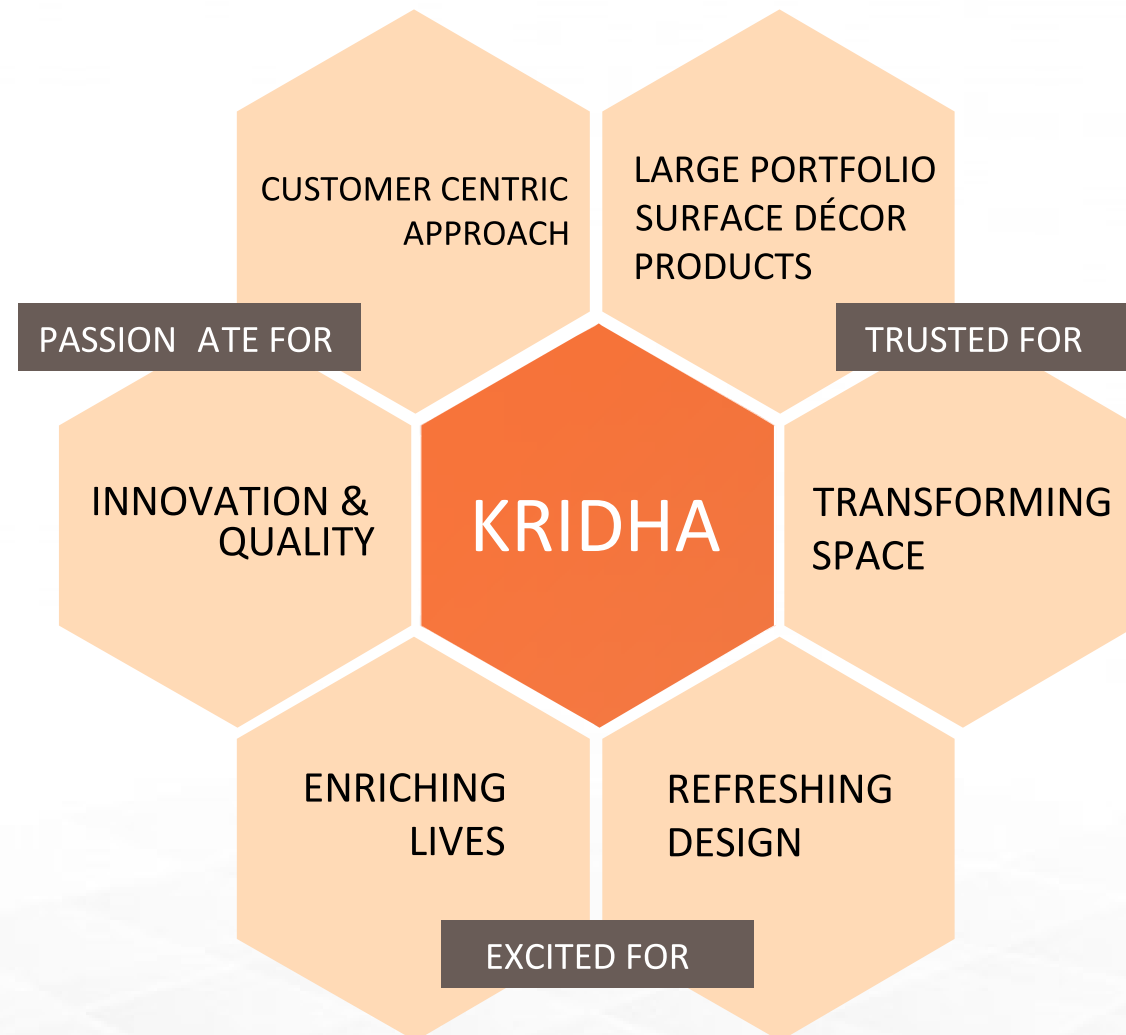

Our goals

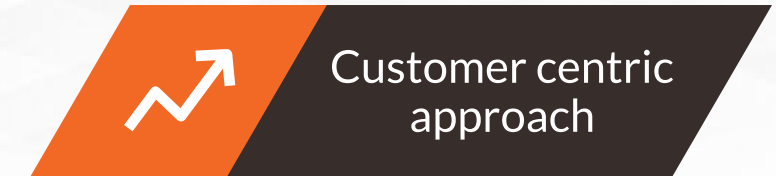



Kridha:

Proudly Present in All 28 States with
the 'Make in India' Concept

As an Indian company, Kridha is committed to the '**Make in India**' initiative, ensuring quality and innovation in every product we deliver. Our presence spans across all **28 states**, bringing premium plywood and laminates to every corner of the country. Choose Kridha for products that are truly made in India, by India, for India.

Pan India

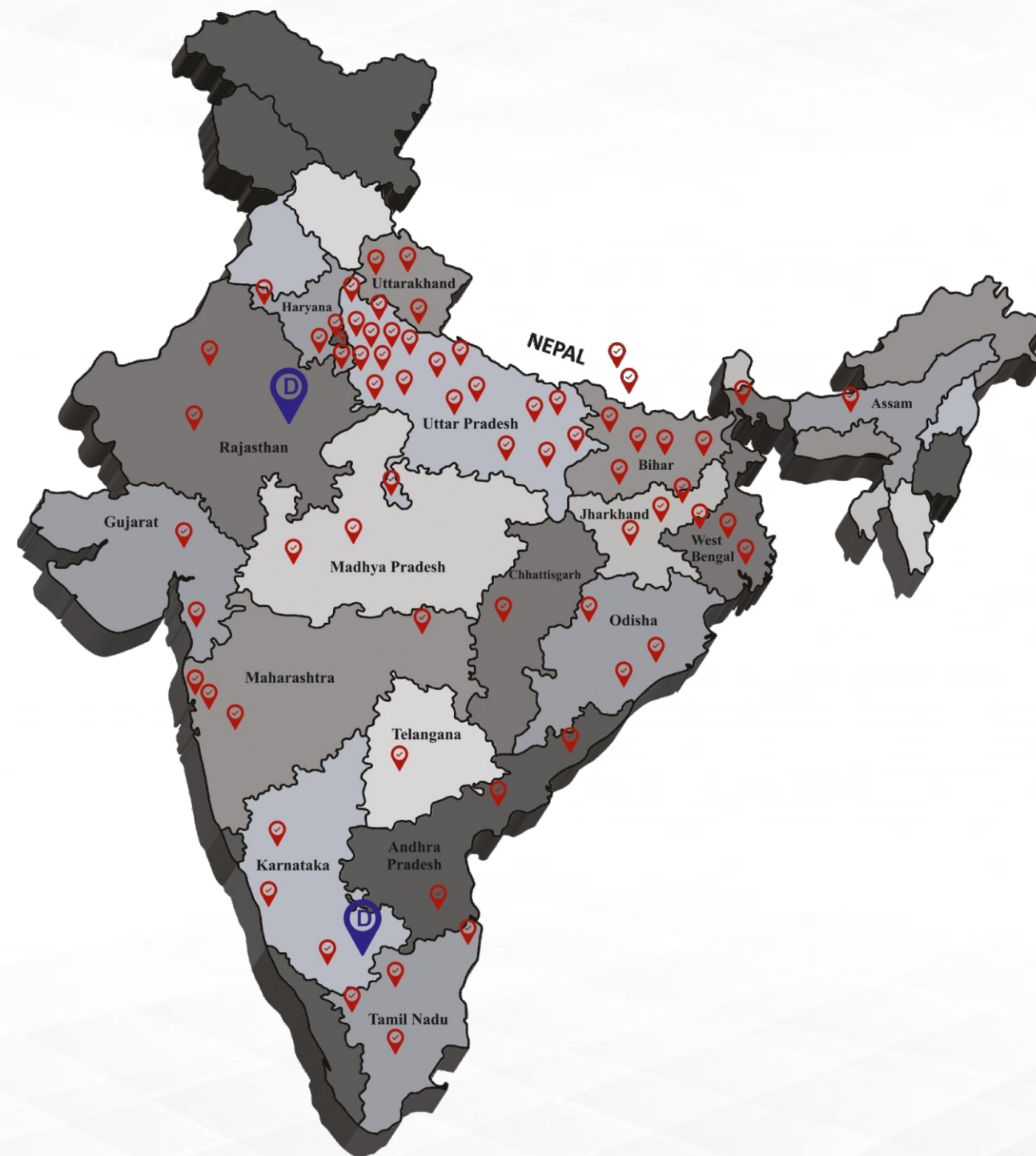

Key Milestones

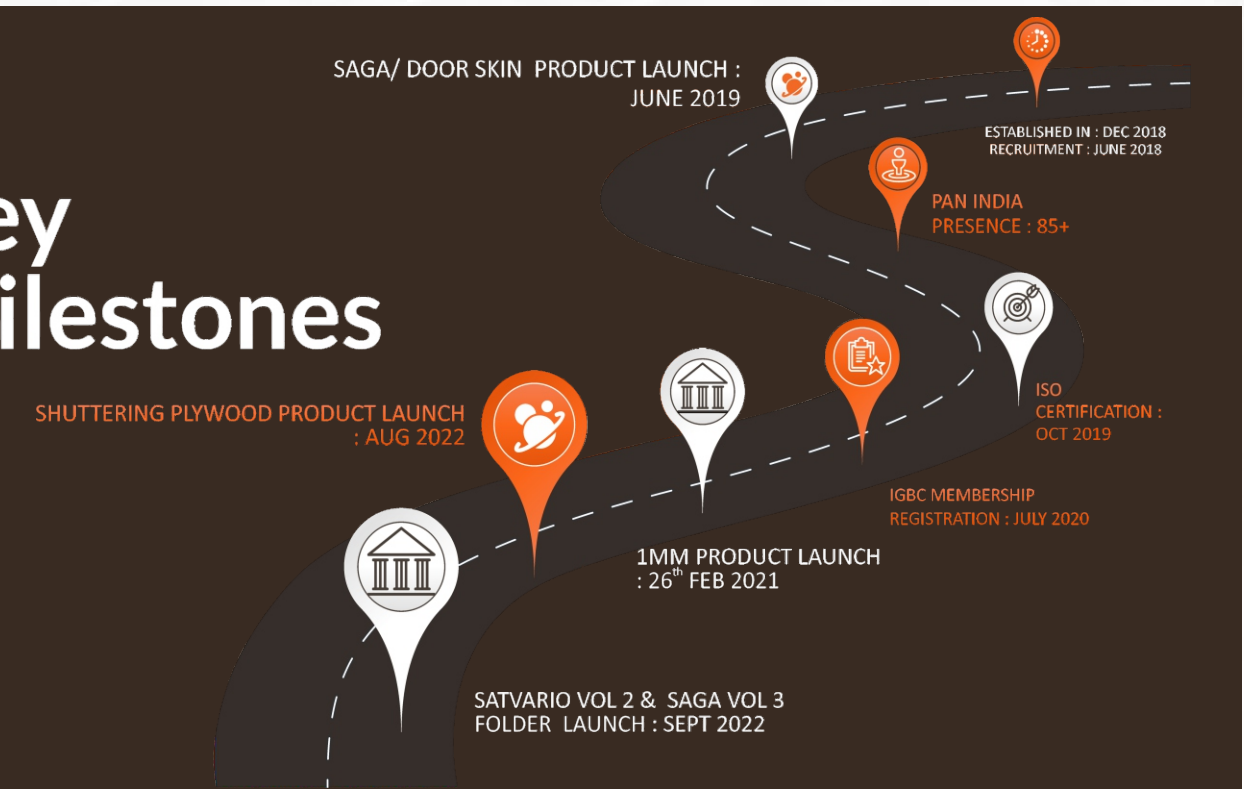

Distributor	:	150+
Dealer	:	16000+
Network	:	58000+
Corporate Client	:	4700+

Depot

Bareilly, Bangalore, Jaipur, Patna

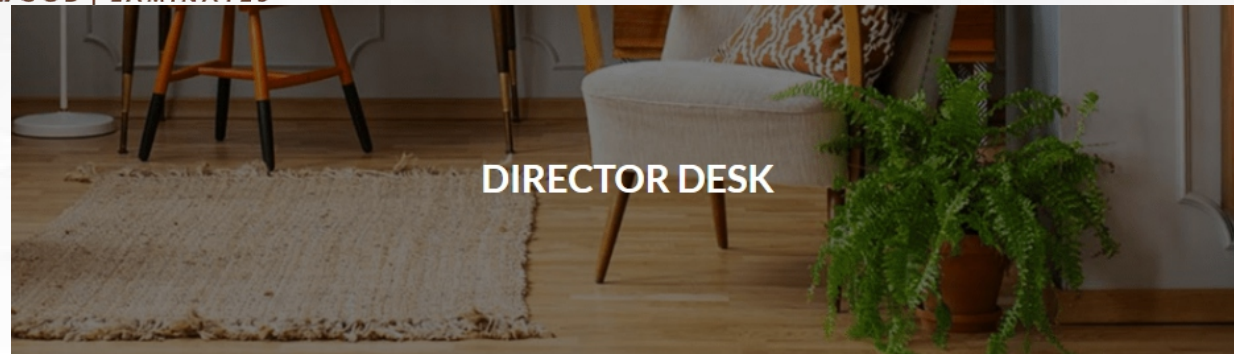

DIRECTOR DESK

At Kridha, we believe that each employee contributes directly to the growth & success of the company & we hope you will take pride in being a member of our team. We believe that professional relationships are easier when all employees work as a team and understand the culture & values of the organization. We hope that experience here will be challenging, enjoyable & rewarding.

Our mission is to deliver unparalleled quality and innovation in every product. Our commitment to excellence drives us to continuously enhance our offerings and exceed customer expectations. We are proud to be industry leaders, dedicated to sustainability and integrity in all we do. Thank you for your trust and partnership as we continue to build a brighter future together.

Ramesh Agrawal
Director



Our journey has been marked by a relentless pursuit of excellence and innovation. As we continue to grow and evolve, our commitment to delivering the highest quality products and exceptional service remains unwavering. Our success is built on the foundation of our core values—integrity, dedication, and customer satisfaction.

Roshan Agrawal
Director



We believe in delivering the best of products to the customers to attain maximum satisfaction. As there is a saying, If you take care of your employees, your employees will take care of your customers and your customers will take care of your business.

Aakash Choudhary
Director

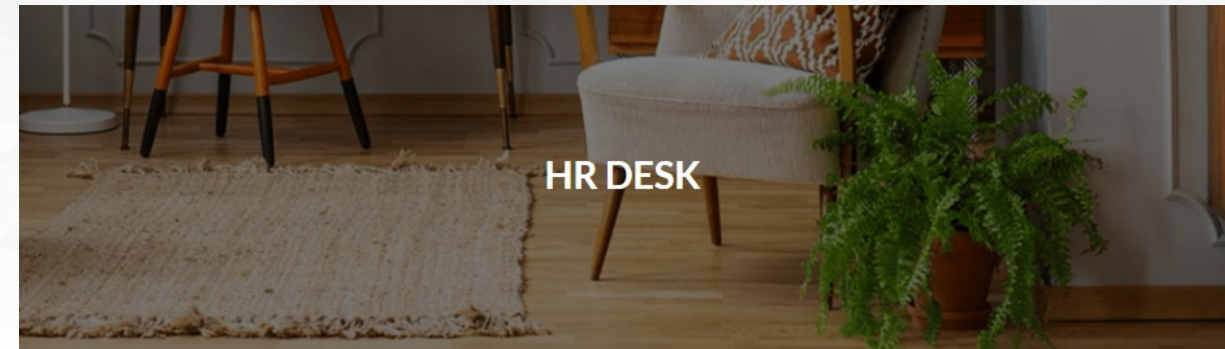

HR DESK

We as your HR Team will ensure to make this association a fun-filled journey towards maximum learning & growth. The policies of Kridha are subject to periodic reviews to keep them relevant & contemporary to employees' & business requirements. The HR Team at Kridha believes in the mantra "Employee's first" & hence we will always go the extra mile for you to make our association productive & each milestone enjoyable. Enjoy the journey at Kridha !

We are dedicated to creating a workplace that encourages growth, innovation, and collaboration. By investing in our team's development and fostering a culture of inclusivity, we ensure that everyone can thrive and contribute to our collective success. Our strength lies in our people.

Mansi Saxena
HR



OUR CHERISH

01

A GREAT team...

02

A relationship with
our channel
partners

03

Value being
demonstrated in
marketing to our end
customer

04

Delighted Channel
partners

05

Economics
Scenario

Deliverables

Quality
Assurance

Mechanized
Process

ISO Certified for all the
units

Using most updated industry
process & Practices.

Operating
Capacity

- 40 lakh sheets per annum in the laminates segment.
- 2000 Ton Plywood Monthly
- 72 Thousand shuttering sheets per month



A REAL STRENGTH
PLYWOOD,
THAT IS
FOUR TIMES MORE
STONGER THAN
ANY OTHER
PLYWOOD



10 Reasons to choose KRIDHA PLYWOOD

The new generation plywood, Manufactured by
4 times pressing technology.

Assembled with 8x4ft core and panel.

Completely free from inside core and panel gap.

Composed core and panel uses in assembly to
strengthen bonding and strength.

Three times treated plywood against termites,
borer and other wood destroying organisms.

Manufactured with 100% Hard wood
for higher strength and life.

Both side calibrated plywood for superior
finishing of wood furniture.

Eco- friendly plywood, safe to use even for kid's room
furniture.

Bonded with high solid content resin for
long life and superior bonding.

High screw holding capacity due to high density
and composed 8x4ft core and panel.



Features



4 Times
More
Stronger
Plywood
Product
Range

KRIDHA
Calibrated
PLYWOOD

KRIDHA
Frd Plywood
FIRE RETARDENT PLY

KRIDHA
Diamond
MARINE GRADE

KRIDHA
Gold
BWR GRADE

KRIDHA
Flush
DOOR

KRIDHA
Prelaminate
DOOR

KRIDHA
Block Board

Other Products :

DOOR SKIN

SAGA
0.8 DECORATIVE LAMINATE

SATVARIO
1MM LUXURIOUS LAMINATE



4times
PRESSED

ASSEMBLED WITH
8X4ft. CORE

0 ZERO
GAP

HIGH DENSITY
HARD WOOD

MADE WITH
MATTIPLY

DOUBLE
CALIBRATED

INTRODUCING 100% COMPOSED CORE CALIBRATED PLY WITH DUAL HOT PRESS ADVANCE TECHNOLOGY

KRIDHA CALIBRATED BWP STRUCTURAL PLYWOOD is a premium quality product used to make furniture of high quality and precision. This most premium product is manufactured by using selected imported wood species to get the full length 8x4 core veneer.

KRIDHA CALIBRATED BWP STRUCTURAL PLYWOOD is made of 100 % hard wood core of high density. It is environment friendly as it is renewable, recyclable. The sustainable and most durable, KRIDHA CALIBRATED product is best for permanent, strong, structural purposes and engineered application.

Prepared with high solid content PF resin, KRIDHA BWP STRUCTURAL Plywood is preservative treated with most trusted vacuum pressure impregnation to make it insect attack proof. It is versatile, reliable and predictable offers a guaranteed performance.

Composed core are four times pressed and double calibrated with numeric controlled calibrator to get perfect thickness and smooth surface finish.

It is dimensionally stable and manufactured to a strict specification with calibrated and uniform thickness of tolerance of +/- 0.15 mm. It has 0.4 mm plus thickness of face veneer that ensures a split free and flaw less top Surface finish.

It is top architectural club class product that conforms to IS 710(marine grade), IS 5509(fire retardant grade) and IS 10701(structural grade) all together. It uniquely offers 'Low formaldehyde emission levels for healthy living conforming to E1 standards of European union.

100% Calibration
Through Advance
EUROPEAN
Machinery & Technology

KRIDHA
PLYWOOD | LAMINATES



In House: Pneumatic Overline Solution

USP :

- Having high structural load capacity
- Confirms to standards - IS 710, IS 5509, IS 10701
- Contains very high mechanical properties
- Reliable and safe for intended life of the structural component
- Borer & Termite Resistant
- Having high density
- Fire resistance of 60 min
- Four times pressed plywood

Applications:

It can be used in Silos, Sheathing, Rail and Ship Containers, Plywood web beams, Stress skin panels, Ships, Bus coaches, Cinema Halls, High rise buildings, Restaurants, Railway Coaches, Vehicle Bodies in Boiler House, Kitchen, Inner Roof Wall Linings, Exhibition Stalls, Public places, Offices, Homes etc.

All interior and interior wood work, Any type of furniture, can be compared like a solid plank with no weather driven bending tendency,

Thickness: 6mm, 9mm, 12mm, 16mm, 19mm
Sizes: 8'x 4', 7'x4', 6'x4', 8'x3', 7'x3', 6'x3'



Life Time

WARRANTY

KridhaDiamond Club

IS: 710



MARINE TECHNICAL SPECIFICATIONS (IS:710:2010)			
	Dimensions	ISI Requirements	Observed Values
1.	Length	2440 + 6 0	2442mm
2.	Width	1220 + 3 0	1222mm
3.	Thickness	19mm ± 5%	18.60mm
4.	Squareness	2mm/1000mm	0.96mm
5.	Edge straightness	2mm/1000mm	0.52mm
Physical properties			
6.	Density	0.65	0.651
7.	Moisture contents	5 – 15%	7.35%
8.	Adhesion of plies (in dry state)	Some adherent fibre distributed more or less uniformly	Satisfactory
9.	Adhesion of plies (in wet state)	do	Satisfactory
10.	Glue shear strength (in dry state)	Avg. — 1350N Ind. — 1100N	1425N 1188N
11.	Glue shear strength (in wet state)	Avg. — 1000N Ind. — 800N	1272N 930N
12.	Tensile strength	Along the grain 42.0N/mm ² Across the grain 25.0N/mm ² TOTAL 84.5N/mm ²	60.05N/mm ² 40.20N/mm ² 100.25N/mm ²
13.	STATIC BENDING STRENGTH (DRY STATE)		
	Along the grain M.O.E. Across the grain M.O.E.	Avg. — 7500N/mm ² Ind. — 6700N/mm ² Avg. — 4000N/mm ² Ind. — 3600N/mm ²	8510 N/mm ² 7250 N/mm ² 4850 N/mm ² 4105 N/mm ²
	Along the grain M.O.R. Across the grain M.O.R.	Avg. — 50 Ind. — 45 Avg. — 30 Ind. — 27	68 N/mm ² 55 N/mm ² 48 N/mm ² 29 N/mm ²
14.	STATIC BENDING STRENGTH (WET STATE)		
	Along the grain M.O.E. Across the grain M.O.E.	Avg. — 3570N/mm ² Ind. — 3400N/mm ² Avg. — 2000N/mm ² Ind. — 1800N/mm ²	4520 N/mm ² 3750 N/mm ² 2890 N/mm ² 2230N/mm ²
	Along the grain M.O.R. Across the grain M.O.R.	Avg. — 25 Ind. — 22 Avg. — 15 Ind. — 13	37 N/mm ² 25 N/mm ² 21 N/mm ² 15 N/mm ²
15.	Retention of preservatives (ACC)	12kg /m3	12.98kg /m ³
16.	Mycological Test a) Show no separation sign. b) Glue shear strength c) Adhesion of plies	Avg. — 1000N Ind. — 800N Adherent fibre distributed more or less uniformly	Satisfactory 1250 N 1010 N Excellent

SIZES : 8x4, 7x4, 8x3, 7x3, 6x4, 6x3

THICKNESS : 4mm, 6mm, 9mm, 12mm, 16mm,18mm, 25mm

CERTIFICATIONS : IS 710, ISO 9001: 2015

USP :

- 100% Marine Grade
- Made with MATT ply making process
- Made with 8x4ft. core and panel
- Borer and Termite resistant.
- High resistance to all climatic conditions
- Glue Line Protection and Preservative treatment
- Manufactured using selected eco-friendly timber



LIFETIME WARRANTY

Kridha FRD Fire Retardent ply

IS: 5509

KRIDHA Platinum Plywood is advisable to be used in public places, where the risk of fire has to be reduced. The areas such as in kitchen woodwork of large restaurants, interior woodwork public auditoriums, theatres and banquet halls. KRIDHA Platinum FR Plywood is very suitable for every application in premium homes and villas as it confirms to all requisites of IS 710 and IS :5509. It can be used in railway

Compartments of railway trains or other public transport or station facilities. KRIDHA Platinum FR Plywood is the most suitable plywood panel for high rise commercial buildings as this will prevent the occupants from fire and fumes for an extended period of time to provide enough escape time.

KRIDHA Platinum FIRE RETARDANT PLYWOOD is manufactured as per IS:5509 specifications that ensures the rate of burning of the plywood extended beyond 20 minutes. The time taken for flames to penetrate in KRIDHA Platinum fire retardant Plywood is beyond 30 minutes.

PROTECTION TIME : 40 min, 60 min,120 min.

RESISTANCE :

It resists Spark and Ignite without any penetration.

It offers 30 % lesser smoke generation with extended flame penetration time.

It offers very Slow burning, having a decreased tendency of the fire to spread over the surface of the plywood,

SIZES : 8x4, 7x4

THICKNESS : 6mm, 9mm, 12mm, 16mm, 19mm, 25mm

USP :

- Lesser tendency of spark and ignite
- Slow burning
- Decreased chances of fire to spread over the surface of the plywood
- Low flammability and lesser smoke generation
- Higher flame penetration time
- Specially formulated fireproofing chemicals infusion
- High density



100% FIRE RETARDANT PLYWOOD & BOARDS

FIRE RETARDANT TECHNICAL SPECIFICATIONS (IS:5509:2010)			
	DIMENSIONS	BIS REQUIREMENTS	OBSERVATION VALUES
1.	Length	2440 + 6 0	2442mm
2.	Width	1220 + 3 0	1222mm
3.	Thickness	12mm ± 5%	11.80mm
4.	Squareness	2mm/1000mm	0.95mm
5.	Edge straightness	2mm/1000mm	0.50mm
6.	Workmanship & finish	As per clause 9.1 to 9.2	Satisfactory
Physical properties			
7.	Density	0.60 – 0.65	0.64
8.	Moisture contents	5 – 20%	10.25%
9.	Water resistance test Cyclic test 8 hours – 16 hours Boiling – drying 3 Cycles	Pass standard	Excellent
10.	Mycological Test	Pass standard	Excellent
11.	Static bending strength	Avg. – 5000N/mm ² Ind. – 4500N/mm ²	5850 N/mm ² 4020 N/mm ²
	Along the grain M.O.E.	Avg. – 2500N/mm ² Ind. – 2200N/mm ²	3480 N/mm ² 2855 N/mm ²
	Across the grain M.O.E.	Avg. – 40 Ind. – 36	47.80N/mm ² 36.40N/mm ²
	Along the grain M.O.R.	Avg. – 20 Ind. – 18	27.25N/mm ² 20.35N/mm ²
	Across the grain M.O.R.		
FIRE RETARDANT TESTS IS : 5509 : 2000			
12.	Flammability	30 Min.	35 Min.
13.	Flame penetration	30 Min.	33 Min.
14.	Rate of burning	20 Min. (Wt. loss 30 to 70%)	28 Min.

4times
PRESSED

ASSEMBLED WITH
8X4ft. CORE

ZERO
GAP

HIGH
DENSITY
HARD
WOOD

MADE WITH
MATTPLY

DOUBLE
CALIBRATED



Kridha Gold
BWR Grade IS: 303

15
YEARS
WARRANTY

Made with high grade Treated and 8x4ft. wood veneers from matured plantation timber of Eucalyptus and Poplar, each panel is made with extreme precision and care. KRIDHA GOLD BWR Grade Plywood is four times pressed at 130°C and extreme pressure to compress the veneer-resin pack to obtain superior quality plywood. The 4Times pressed technology act as catalyst to enhance its strength. The bonding process is done using highly viscous 54% solid content Melamine fortified resin which keeps its layers strongly bonded for longer time. To ensure maximum protection, it is treated with unique and specially formulated chemicals to protect every inch from Termite and Borer. KRIDHA GOLD BWR Grade Plywood is both side calibrated plywood. It is dimensionally stable and amazingly durable and ensures satisfaction for the entire woodworking need according to the designers, carpenters and the homeowners.



SIZES : 8x4, 7x4, 8x3, 7x3, 6x4, 6x3

THICKNESS : 4mm, 6mm, 9mm, 12mm, 16mm, 18mm, 25mm

CERTIFICATIONS : IS 303, ISO 9001: 2015

USP :

- Made with MATT ply
- Made with 8x4ft. core and panel
- Manufactured Using Selected Eco-friendly Timber
- Exceeding performance compared to other MR plywood brands
- Optimum Strength and Durability, best suited for commercial interior uses

BWR PLYWOOD TECHNICAL SPECIFICATIONS (IS:303:2010)			
	Test	ISI Requirements	Observed Values
1.	Grade	BWR, MR	BWR
2.	Moisture Content	5-15%	7%
3.	Density	0.65 to 0.70 gm/cm ³	0.70 gm/cm ³
4.	Resistance to Water (3 cycles of hr Boiling & 16 hr Drying at 65OC)- adhesion to plies	Min pass	Excellent
5.	Resistance to Micro Organism- Adhesion to plies	Min pass	Excellent
A.	Modulus of Elasticity - Along the Grain - Across the Grain	Avg. Min 5000 N/mm ² Avg. Min 2500 N/mm ²	7500 N/mm ² 4000 N/mm ²
B.	Modulus of Rupture - Along the Grain - Across the Grain	Avg. Min 40 N/mm ² Avg. Min 20 N/mm ²	60 N/mm ² 35 N/mm ²
6.	Tensile Strength - Along the Grain - Across the Grain - Sum of Tensile Strength	Avg. Min 42.00 N/mm ² Avg. Min 25.00 N/mm ² Avg. Min 84.50 N/mm ²	52 N/mm ² 38 N/mm ² 90 N/mm ²



FLUSH DOOR

IS: 2202

KRIDHA FLUSH BWP grade flush door is a durable product for its excellent quality, exceptional finish and unique dimensional stability. It is made of selected high density wood frames and accurate battens. It is evenly constructed with selected species of timber that matters the most in providing longer life. BWP grade Phenol Formaldehyde resin is used for bonding the layers.

TECHNICAL SPECIFICATIONS (IS:2202)			
	TEST	ISI REQUIREMENT	Observed Value
1	Dimension	Length, Width - + 5 mm Thickness - + 1 mm	Within limits
2	Squareness	Deviation not more than 1 mm on a length of 500mm	Deviation below 1 mm
3	General Flatness	Twist, cupping, warping not to exceed 6 mm	
4	Local Planeness	Depth of deviation at any point to be less than 0.5 mm	Within limits
5	Impact Indentation Test	Depth of Indentation not to exceed 0.2 mm	Within limits
6	Edge Loading Test	Deflection of edge with max. To be less than 5 mm	Within limits
7	Shock Resistance Test	No visible defect after test	No visible defects
8	Buckling Test	Initial deflection - < 50 mm residual deflection - < 5 mm	Within limits
9	Slamming Test	No visible damage after Test	No visible damage
10	Misuse Test	No deformation after Test	No deformation
11	Varying Humidity Test	No visible warping, twisting or de-lamination	No such defects observed
12	End Immersion Test	No de-lemination at the end	No de-lemination
13	Knife Test	Minimum Pass Standard	Excellent
14	Glue Adhesion Test	No de-lamination	No de-lamination
15	Screw Withdraw Test	Load to withdraw screw to be more than 1000 N	Load - > 1000 N

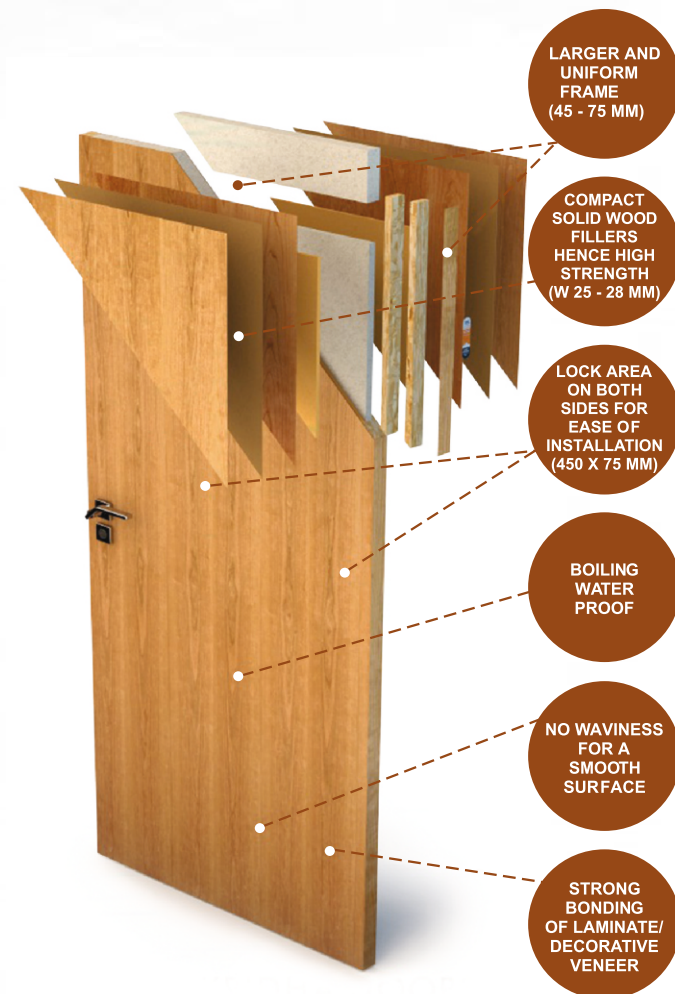

Advantages:

- Manufactured with high solid content resin for higher bonding.
- Free from corrugation and roughness.
- High screw holding capacity.
- High shock resistance.
- Boiling water proof.
- Smooth surface.
- Lab tested and eco friendly.
- Zero gap and zero bending.

Made with
high density wood,
100%Water proof,



Prelaminate Door

KRIDHA[®]
PLYWOOD | LAMINATES

WATER PROOF
100%

For your convenience Kridha offers highly durable laminated Doors. These doors are water-proof and covered with high Pressure Laminate (HPL) sheets which give them their distinctively beautiful finish. Carved from the best raw materials available and cut by latest cutting-edge machines, these all-weather doors are capable of withstanding the harshest of climatic conditions, without even a scratch to their exquisiteness. We use unique technology in which special resins impart extra strength to its laminates, making them highly resistant to scratch and abrasion.

TESTS	IS 2202 (PART-1) REQUIREMENTS	OBSERVATION	OBSERVATION
Workmanship and Finish	Satisfactory	Satisfactory	Satisfactory
Dimensions & Squareness test	Length & width Within a limit 5mm	Length = ±5 mm Width = ±5 mm	Length = ±4 mm Width = ±4 mm
	Thickness Within limit of 1mm(±). variation in thickness Within 0.8mm	Thickness= ±0.8 mm	Thickness= ±0.5 mm
	door shutter shall not deviate by more then 1mm	Within Limit	Within Limit
General flatness test	Twist, cupping, warping not more than 6mm	Within Limit	Within Limit
Local planeness test	Depth of deviation not greater than 0.5mm	Within Limit	Within Limit
Impact indentation	not more than 0.2mm	0.2 mm	0.2 mm
Flexure test	Residual deflection should not more then 1/10 of maximum deflection.	Within Limit	Within Limit
	Deflection at max load should not more than 1/30 of length and 1/15 of width.	Within limit	Within limit
Edge loading test	Deflection of the edge at the maximum load should not more than 5.0mm.	3.24 mm	4.50 mm

4times
PRESSED

ASSEMBLED WITH
8X4ft. CORE

0 ZERO
GAP

HIGH
DENSITY
HARD
WOOD

MADE WITH
MATTPLY

DOUBLE
CALIBRATED



DURABILITY MEETS STYLE.



Premium Finish": Experience the high-quality craftsmanship and luxurious finish of Saga laminates in your space.

Timeless Elegance": Discover the classic beauty of Santorini with our premium laminates, perfect for any stylish interior.



Refined Sophistication": Add a sense of luxury and grace to your home with the high-end finish of Satvario laminates.



Organize your important documents with elegance and durability. Our Acrylic Folders are designed to give a crystal-clear view, a premium feel, and long-lasting protection. Perfect for offices, schools, and businesses that want to leave a professional impression.

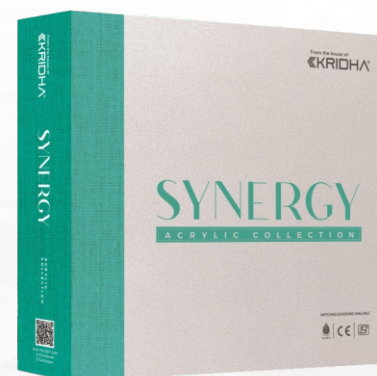

www.kridhalam.com

Your Favourite brand
is now supported with world class website

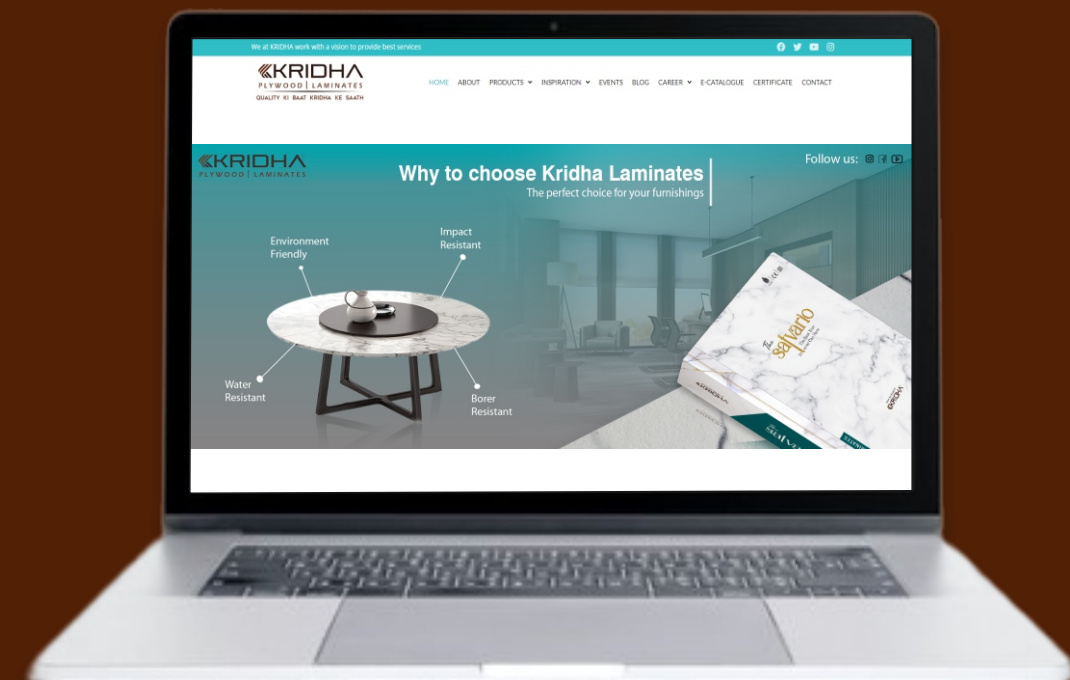

Saathi App is your reliable companion for quick and efficient assistance. Whether you need expert advice, troubleshooting help, or just someone to guide you through a task, Saathi App connects you with trusted professionals and knowledgeable experts, ensuring you get the support you need, when you need it. Your help, your companion, always ready to assist.

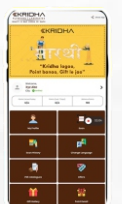



MIRROR FINISH SHUTTERING Plywood

KRIDHA offers customized solutions for its varied customer requirements in the construction, Interior Designing and engineering industries. Its KRIDHA Mirror finish Shuttering Plywood Range of super strong and highly compressed plywood is used in various construction-specific applications for ceiling construction, building structures, materials for rail coach furnishing, automobile body & platforms, materials meant for general engineering, chemical plants, power generation system etc. Film-faced Shuttering Plywood manufacturing by latest semiautomated production process with the automated heating – cooling system. The range of product under KRIDHA Mirror finish Shuttering Plywood offer the best in quality & performance for each of your requirements.



Available Thickness : 12mm

(*Prices exclusive of Taxes & Transportation.
Price may vary according to States.)



KRIDHA
PLYWOOD | LAMINATES

Specifications

- High GSM Film Enhances surface finish & abrasion resistance.
- More reuses/ repetitions reduces overall cost of construction.
- Balanced construction provides high static bending strength.
- Dimensionally stable & structurally strong.
- Less water absorption due to excellent sealing.
- Bigger size availability reduces labour cost, saves time & smooth finish.
- Plywood confirms to IS : 4990.

WATER PROOF
100%

ZERO GAP

Greater Strength Plywood

UNIFORM THICKNESS

***20times**
REPETITION

MADE WITH MATTPLY





KRIDHA
Block Board



BLOCK BOARD

IS: 1659

KRIDHA BWP BLOCK BOARD is made with high density HARD wood core and PINE wood filler. The inside wood battens is prepared with seasoned wood, bonded with BWP Grade (Boiling Water Proof) resin that can endure extreme weather conditions and withstand alternate drying & wetting. KRIDHA BWP boards are waterproof and designed for those who want genuine durable and weather proof quality Block board for their furniture of home interior. The KRIDHA BWP Grade Block boards are exclusive and different from market offering because of its Gapeless filling and composing of battens inside.

KRIDHA BLOCK BOARD undergoes a special process of treatment not only from outside but also inside to develop resistance against micro-organism. The wood battens are dipped and seasoned to enhance borer resistance and to make dimensionally stable thus making it very appropriate for high-quality projects.

SIZES : 8x4,
THICKNESS : 19mm, 21MM, 25mm

- USP :**
- Boiling Water Proof,
 - Compact and Solid,
 - Super Smooth even surface,
 - Termite and borer Resistant
 - Withstands alternate wetting and drying

B/B TECHNICAL SPECIFICATIONS (IS:1659:2010)			
	Test	ISI Requirements	Observed Values
1.	Dimensional changes caused by humidity a) Changes, mm from 65% RH to 90% RH from 65% RH to 40% RH b) Local planeness c) At the extreme range of humidity	+ 1mm Max - 1mm Max. < 1/150 No de-lamination at the extreme range of humidity	+ 0.50 mm - 0.55 mm < 1/175 No de-lamination observed
2.	Adhesion of the plies	Minimum pass standard	Excellent
3.	Resistance to water (72 hours boiling)	No de-lamination after 72 hours boiling	No de-lamination
4.	Resistance to micro organisms	No appreciable sign of separation at edges.	No separation at edges
5.	Modulus of elasticity	Min. 5000 N / sq.mm	6050 N / sq.mm
6.	Modulus of rupture	Min. 50 N / sq.mm	61 N / sq.mm
7.	Spot test	Entire penetration of preservative chemicals through batten	Satisfactory



MINIMUM GAP
BLOCK BOARD,
Both side Calibrated,
Boiling Water Proof,
100% PINE wood+
HARD wood core



KRIDHA
PLYWOOD | LAMINATES
QUALITY KI BAAT KRIDHA KE SAATH



KRIDHA
PLYWOOD | LAMINATES

OTHER PRODUCT

DOOR SKIN

KRIDHA door skin is another innovative way to beautify your entrance. Manufactured using high-quality resins and the finest Kraft paper, KRIDHA door skin represent the finest in laminates, especially designed to appeal to even the most discerning customer with a fine taste for luxury and style. If you too are thinking of using laminated door skin, then KRIDHA is the best option to select beauty and strength for your home entrance.

SAGA 0.8 DECORATIVE LAMINATE

Beautiful interiors not only look attractive but also have the ability to add warmth and appeal to any place. Decorative laminates ensure that the surface interiors of a place look appealing and diffuse a feeling of utter enchantment when looked at. With an array of options available with KRIDHA laminate, most people do not even have second thoughts about using decorative laminates to increase the beauty of their house or office interiors.

SATVARIO 1MM LUXURIOUS LAMINATE

Kridha High Pressure decorative Laminate, SATVARIO, is manufactured with multiple layers of paper under high temperature and pressure to create a bold and beautiful series of surface decor material. Kridha Satvario 1mm Laminate comes in a variety of upbeat hues, nature-inspired tones and well-chosen textures that can be applicable to every inside wood working.

SANTORINI 1MM SPECTACULAR LAMINATE

Santorini Laminate Sheets offer a stunning and versatile design inspired by the picturesque beauty of Santorini. These high-quality laminate sheets feature a blend of elegant patterns and rich textures, perfect for enhancing the aesthetic appeal of any interior space. Ideal for residential and commercial applications, Santorini Laminate Sheets provide durability, easy maintenance, and a sophisticated look, making them a popular choice for modern decor.

Event & Exhibition



Training & Event

